



**MATERIAL**

Hardened AISI 431 stainless steel.

**ELASTIC ELEMENT**

Polyurethane (PUR).

**STANDARD EXECUTIONS**

AISI 420C nickel-plated stainless steel ball:

- **GN 709.15-B**: ball with smooth and flat face, not reversible.
- **GN 709.15-BR**: ball with smooth and flat face, not reversible, with automatic return.

Nickel-plated steel ball:

- **GN 709.15-RH**: ball with knurled and flat face, not reversible.
- **GN 709.15-RRH**: ball with knurled and flat face, not reversible, with automatic return.

**FEATURES AND APPLICATIONS**

GN 709.15 clamping elements are used as mobile supports or for clamping workpieces.

Maximum inclination of the ball plane = 9°.

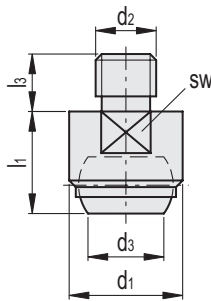
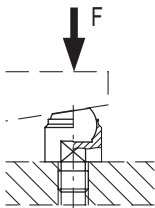

**GN 709.15-B**

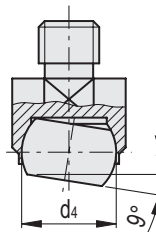

**GN 709.15-BR**

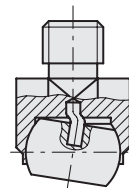

Conversion Table	
1 mm = 0.039 inch	
d1	
mm	inch
13	0.51
20	0.79
30	1.18
50	1.97

**GN 709.15-B**



Code	Description	d1	d2	d3	d4	l1 ±0.02	l3	sw	Max. static load F [kN]	⚖
GN.76251	GN 709.15-13-M6-B	13	M6	7.2	10	13	8	11	10	13
GN.76253	GN 709.15-13-M8-B	13	M8	7.2	10	13	8	11	10	13
GN.76261	GN 709.15-20-M8-B	20	M8	10.5	16	18	10	17	25	38
GN.76263	GN 709.15-20-M10-B	20	M10	10.5	16	18	10	17	25	40
GN.76265	GN 709.15-20-M12-B	20	M12	10.5	16	18	12	17	25	43
GN.76271	GN 709.15-30-M16-B	30	M16	20	25	27	16	27	90	150
GN.76276	GN 709.15-50-M20-B	50	M20	34.5	40	35	20	41	165	488
GN.76281	GN 709.15-50-M24-B	50	M24	34.5	40	35	24	41	165	512

**GN 709.15-BR**



Code	Description	d1	d2	d3	d4	l1 ±0.02	l3	sw	Max. static load F [kN]	⚖
GN.76252	GN 709.15-13-M6-BR	13	M6	7.2	10	13	8	11	10	12
GN.76256	GN 709.15-13-M8-BR	13	M8	7.2	10	13	8	11	10	13
GN.76259	GN 709.15-20-M8-BR	20	M8	10.5	16	18	10	17	25	37
GN.76264	GN 709.15-20-M10-BR	20	M10	10.5	16	18	10	17	25	38
GN.76268	GN 709.15-20-M12-BR	20	M12	10.5	16	18	12	17	25	42
GN.76272	GN 709.15-30-M16-BR	30	M16	20	25	27	16	27	90	147
GN.76277	GN 709.15-50-M20-BR	50	M20	34.5	40	35	20	41	165	482
GN.76282	GN 709.15-50-M24-BR	50	M24	34.5	40	35	24	41	165	511

Machine elements